



Skatepark Řeporyje
U / U Studio

TRANSFORMING ŘEPORYJE: WHERE SPORT MEETS ART

Posted on February 12, 2025 by Dima Fadel



Categories: [Energy and sustainability](#), [expanding design practices](#), [Middle Density](#), [Project](#), [U / U studio](#)

Tags: [Art for the City](#), [brownfield transformation](#), [community engagement](#), [community-driven project](#), [cultural hub](#), [cultural integration](#), [Czech sculptors](#), [Landscape Architecture](#), [leisure park](#), [modern infrastructure](#), [multifunctional sports area](#), [outdoor cinema](#), [outdoor recreation](#), [parkour](#), [pedestrian connectivity](#), [Prague](#), [public amenities](#), [public art](#), [public lighting](#), [public sculpture](#), [Public Space](#), [pump track](#), [recreation area](#), [Řeporyje](#), [Skateable City](#), [Skateboarding](#), [skatepark](#), [Social Inclusion](#), [sports and culture](#), [sustainable design](#), [Urban design](#), [Urban planning](#), [Urban renewal](#)

urbanNext Lexicon

Transforming Řeporyje: Where Sport Meets Art
<https://urbannext.net/transforming-reporyje-where-sport-meets-art/>

The proposal for the leisure activity park in Řeporyje originated from the residents of the city district and their need for a multifunctional sports and leisure area. The project's objective was to create a safe and attractive public space that offers versatility for various age groups and social demographics. The design includes a skatepark, parkour area, pump track, picnic tables with grills, and a wooden stage for events and outdoor cinema—all seamlessly integrated into one space. A significant element of the proposal is the inclusion of statues by some of the most renowned Czech sculptors. These sculptures, funded by the "Art for the City" project, engage in a direct dialogue with the composition and elements of the sports facility, creating an unexpected synergy between movement and art. The project also features new public lighting, a ping-pong table, a charging station, and a water fountain—essential amenities for a space like this. Additionally, public toilets and a snack bar are included as separate design elements.



ISSN : 2575-5374

urbanNext Lexicon

Transforming Řeporyje: Where Sport Meets Art
<https://urbannext.net/transforming-reporyje-where-sport-meets-art/>



ISSN : 2575-5374

urbanNext Lexicon

Transforming Řeporyje: Where Sport Meets Art
<https://urbannext.net/transforming-reporyje-where-sport-meets-art/>



ISSN : 2575-5374

urbanNext Lexicon

Transforming Řeporyje: Where Sport Meets Art
<https://urbannext.net/transforming-reporyje-where-sport-meets-art/>



The main paved surface consists of smoothened concrete, ensuring an unobstructed ride. A section of the concrete is pigmented with earth tones, complementing the sculptures and helping the design blend into its surroundings. A diagonal pedestrian path, made of concrete tiles, enhances orientation within the space. The edges of obstacles and pipe elements are made of painted steel, as is the structure of the wooden podiums. Areas dedicated to relaxation are defined by yellow decomposed granite, which enhances the park's natural character and helps mitigate overheating. Rainwater is absorbed on-site through an underground drainage system.

The removal of the fence will open the area to promote social safety and inclusion, welcoming people from different backgrounds and sports communities. Public lighting ensures the park

urbanNext Lexicon

Transforming Řeporyje: Where Sport Meets Art
<https://urbannext.net/transforming-reporyje-where-sport-meets-art/>

remains visible throughout the day, allowing skatepark use into the late evening. The diagonal path across the site creates a direct connection between the BUBEC art center and the town center. The park is well integrated with existing pedestrian paths and pavements. Seating steps incorporated into the sloped landscape provide excellent views of both the park and the scenic valley beyond.

A former brownfield site in Prague Řeporyje has been transformed into a new leisure activity park, bridging sports and culture. Given its proximity to the existing BUBEC artists' center, the park aspires to become a new cultural hub for the Prague district.



ISSN : 2575-5374

urbanNext Lexicon

Transforming Řeporyje: Where Sport Meets Art
<https://urbannext.net/transforming-reporyje-where-sport-meets-art/>



ISSN : 2575-5374



Materials

- Smoothened concrete: Skatepark flooring, obstacles, radii, seating steps
- Steel: Edges of obstacles, pipe elements, urban furniture, public lighting, sculptures
- Concrete tiles: Diagonal path
- Cor-Ten steel: Sculptures
- Larch wooden planks: Podiums, urban furniture

urbanNext Lexicon

Transforming Řeporyje: Where Sport Meets Art
<https://urbannext.net/transforming-reporyje-where-sport-meets-art/>

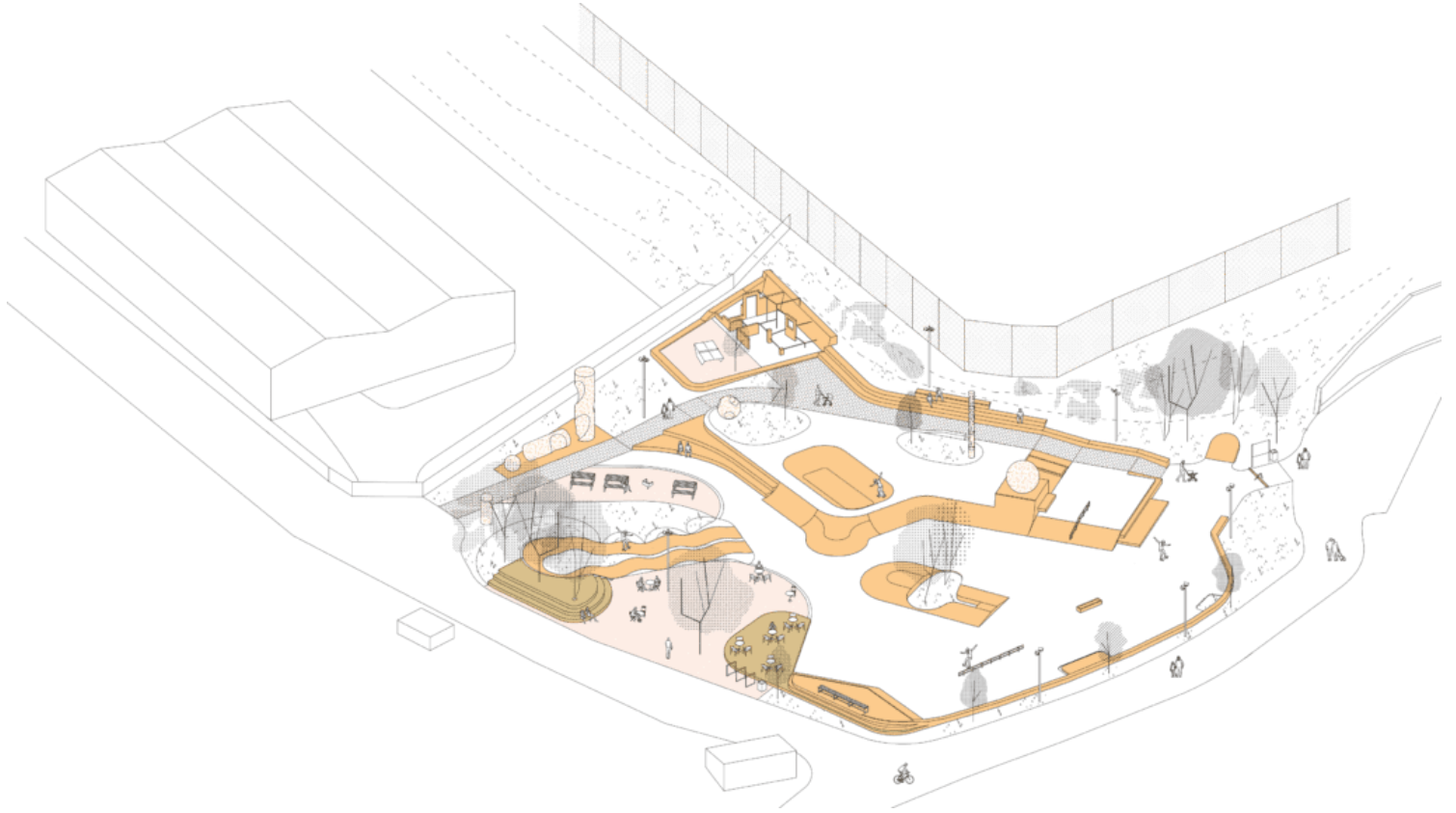

ISSN : 2575-5374

urbanNext Lexicon

Transforming Řeporyje: Where Sport Meets Art
<https://urbannext.net/transforming-reporyje-where-sport-meets-art/>

ISSN : 2575-5374