

REPURPOSING KRONOS: A CULTURAL AND COMMUNAL CAPACITOR IN ELEFSINA

Posted on January 15, 2025 by Dima Fadel



Categories: [Education](#), [Essay](#), [Formats](#), [National Technical University of Athens](#), [Nicholas Anastasopoulos](#), [Politics and economics](#), [Territory and mobility](#)

Tags: [Architecture School](#), [Architecture's role](#), [Cultural legacy](#), [Culture](#), [Design thinking](#), [Developing policies](#), [Education](#), [Environment](#), [Essay](#), [KRONOS](#), [Landscape](#), [Learning](#), [Legacy](#), [Students](#), [Theory](#), [Thesis](#)

Focusing on the former alcohol industry site, *KRONOS*, in Elefsina, this students' work explores a methodological approach for the reuse of an inactive area of the city and its coastal front. The goal is to achieve the densification of the urban fabric and integrate these dormant structures into the contemporary life of the city.

Elefsina, a city with 30,000 inhabitants and a rich historical background, is characterized by its strong legacy of deindustrialization. This transformation is evident both through direct observation—via peripatetic walks analyzing urban conditions across various areas and neighborhoods —and through the city's documented urban development and organization over time, as recorded in relevant literature.

Over the years, Elefsina has experienced significant demographic and spatial transformations. It has absorbed large waves of internal and external migration while hosting a considerable portion of the country's industrial activity during the 20th century. The urban scale of the city and its neighborhoods stands in stark contrast to the size of its active and inactive industrial facilities, as well as the more recently established logistics centers and warehouses.

To determine effective interventions in such an urban environment marked by intense contrasts, the study employed several methodological tools. These included informal discussions with locals, participation in community activities, and the organization of a participatory workshop. This workshop focused on identifying the city's threats and opportunities within the framework of 2023 *ELEYSIS: European Capital of Culture* .

urbanNext Lexicon

Repurposing Kronos: A Cultural and Communal Capacitor in Elefsina
<https://urbannext.net/repurposing-kronos-a-cultural-and-communal-capacitor-in-elefsina/>

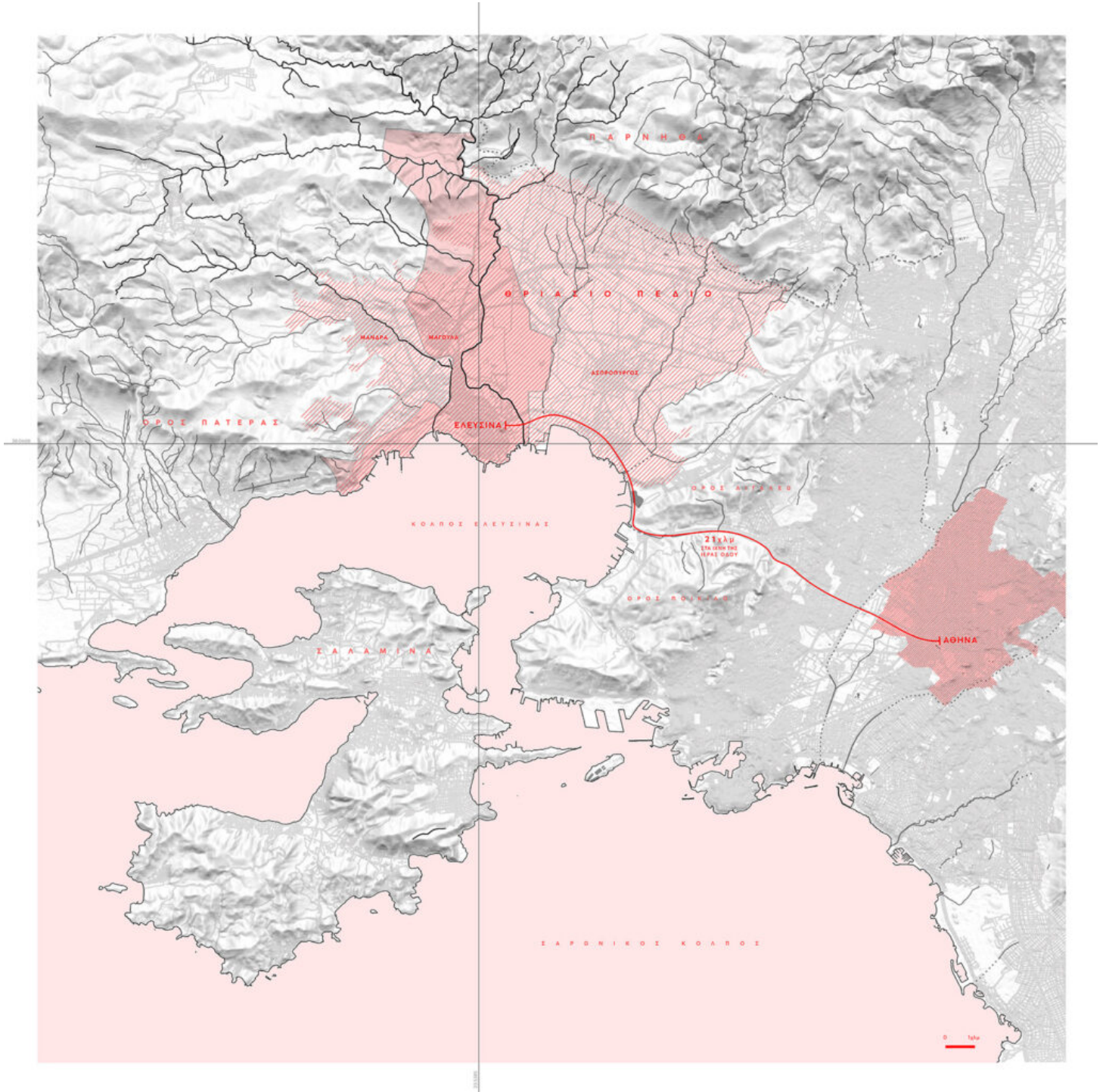

ISSN : 2575-5374

Figure 1: Elefsina is a city in the plain of Thriasio, bordered by the Gulf of Elefsina

urbanNext Lexicon

Repurposing Kronos: A Cultural and Communal Capacitor in Elefsina
<https://urbannext.net/repurposing-kronos-a-cultural-and-communal-capacitor-in-elefsina/>

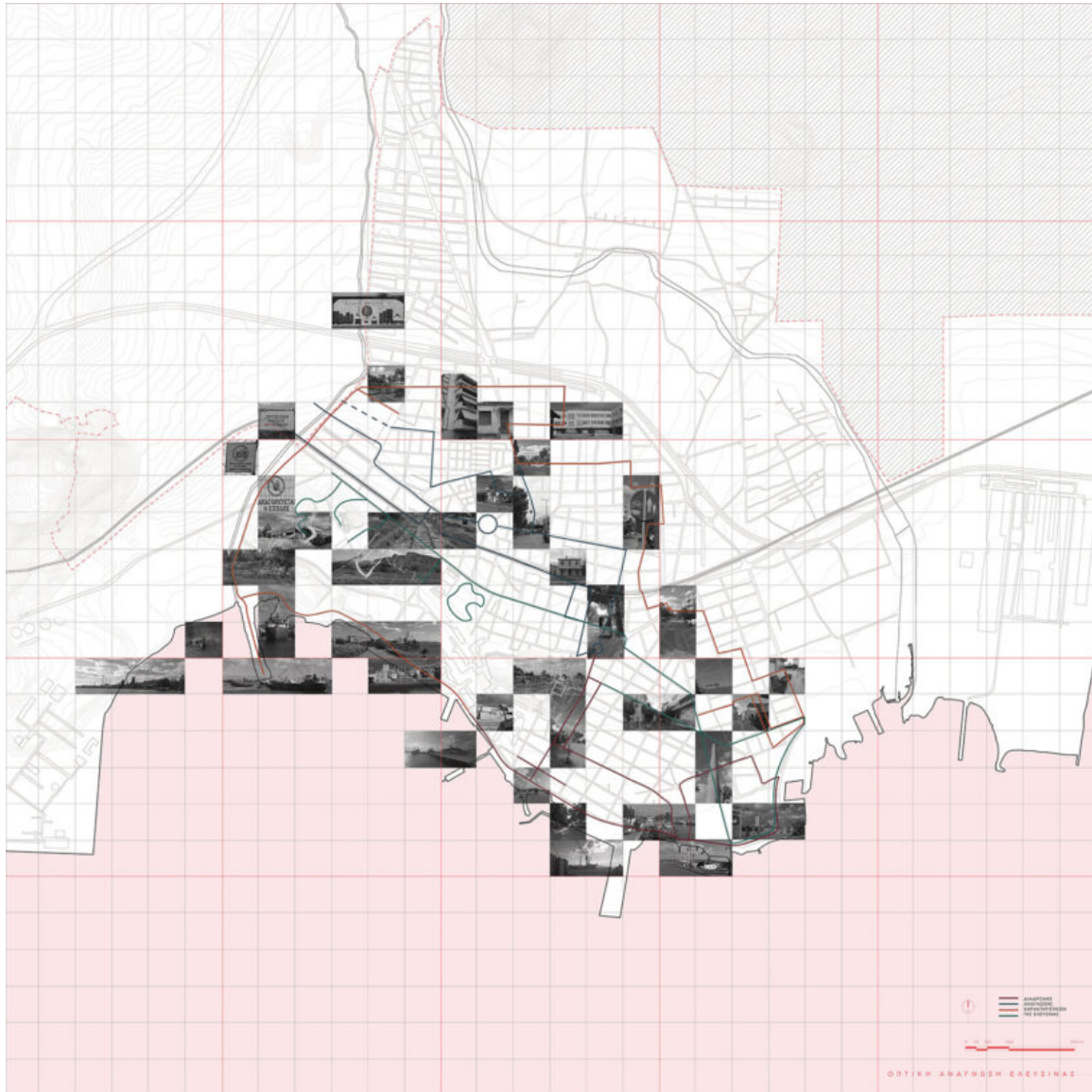

ISSN : 2575-5374

Figure 2: Walking routes followed in the city of Elefsina

The research process revealed the extent to which the city of Elefsina is "fenced" by industries—both operational and abandoned—cut off from its coastal front, and the deep concerns of its residents regarding the future of its shoreline and neglected industrial monuments.

One of the most significant industrial landmarks in Elefsina, due to its historical, architectural, and collective memory value, is the alcohol industry *KRONOS* (1923–1986), located at the southeastern edge of the city. This complex is situated within a dynamic residential neighborhood comprising general housing, educational and sports facilities, public squares and parks, social services, cultural spaces, and newly built social housing complexes. Despite its strategic location and historical significance, *KRONOS* remains fenced off, with an overwhelming sense of abandonment prevailing. The complex includes historically important buildings, two of which have been officially listed as heritage sites.

KRONOS is approached as a *terra incognita* —an inactive space with the potential to assume a new role in the public, communal, and private life of the city. It offers an opportunity to become a site of supra-local importance while simultaneously integrating into the daily life of Elefsina's residents.

urbanNext Lexicon

Repurposing Kronos: A Cultural and Communal Capacitor in Elefsina
<https://urbannext.net/repurposing-kronos-a-cultural-and-communal-capacitor-in-elefsina/>

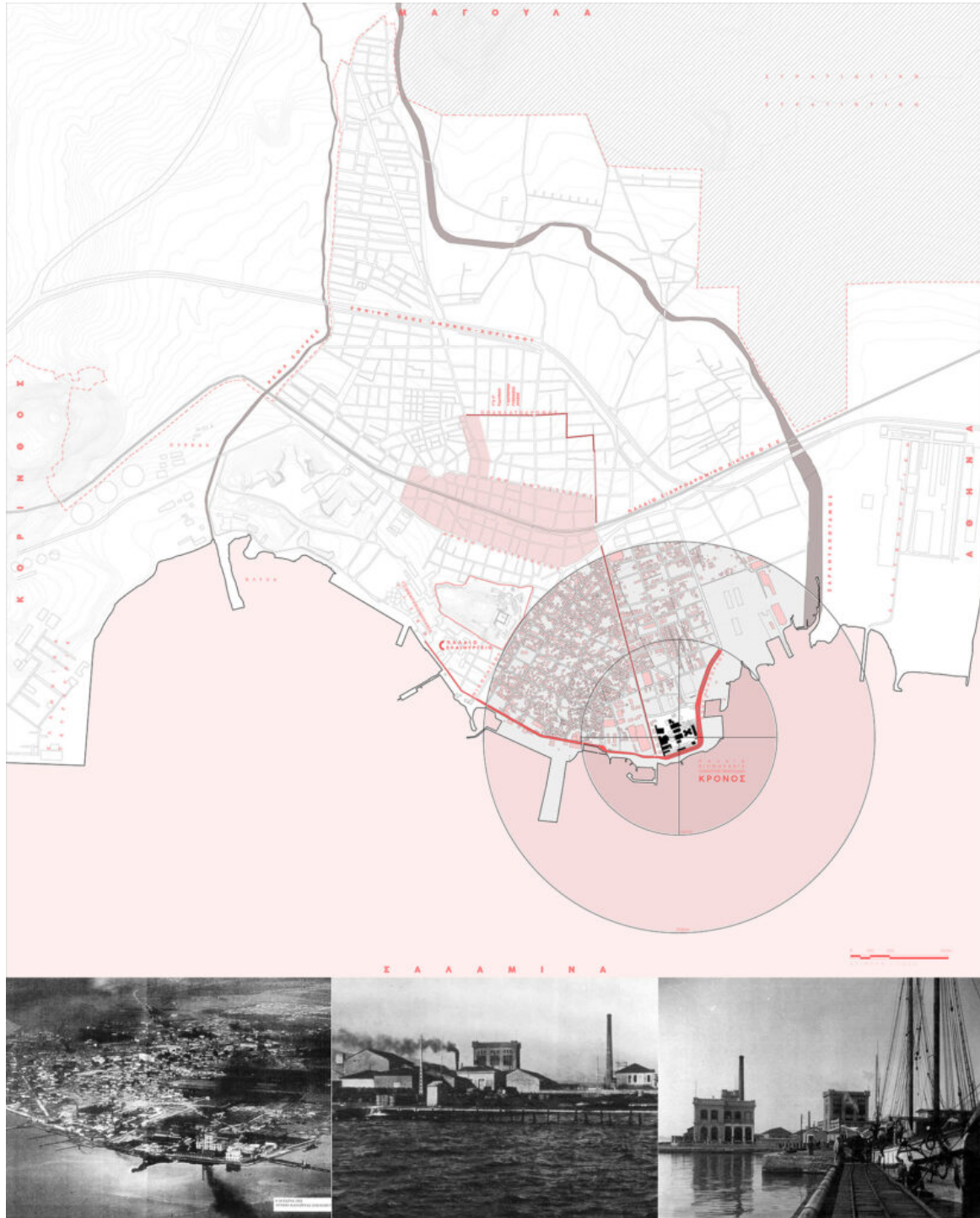

ISSN : 2575-5374

Figure 3: The location of the industrial complex "KRONOS" and historical photos. Source: (Left) archive of Katerina Pavlopoulou, (Center) "posimon ydor", ("Right") M.Papadopoulou / Dinos Roussis.

urbanNext Lexicon

Repurposing Kronos: A Cultural and Communal Capacitor in Elefsina
<https://urbannext.net/repurposing-kronos-a-cultural-and-communal-capacitor-in-elefsina/>



ISSN : 2575-5374

Figure 4: Personal design and photographic documentation of the current state of the "KRONOS" industrial complex

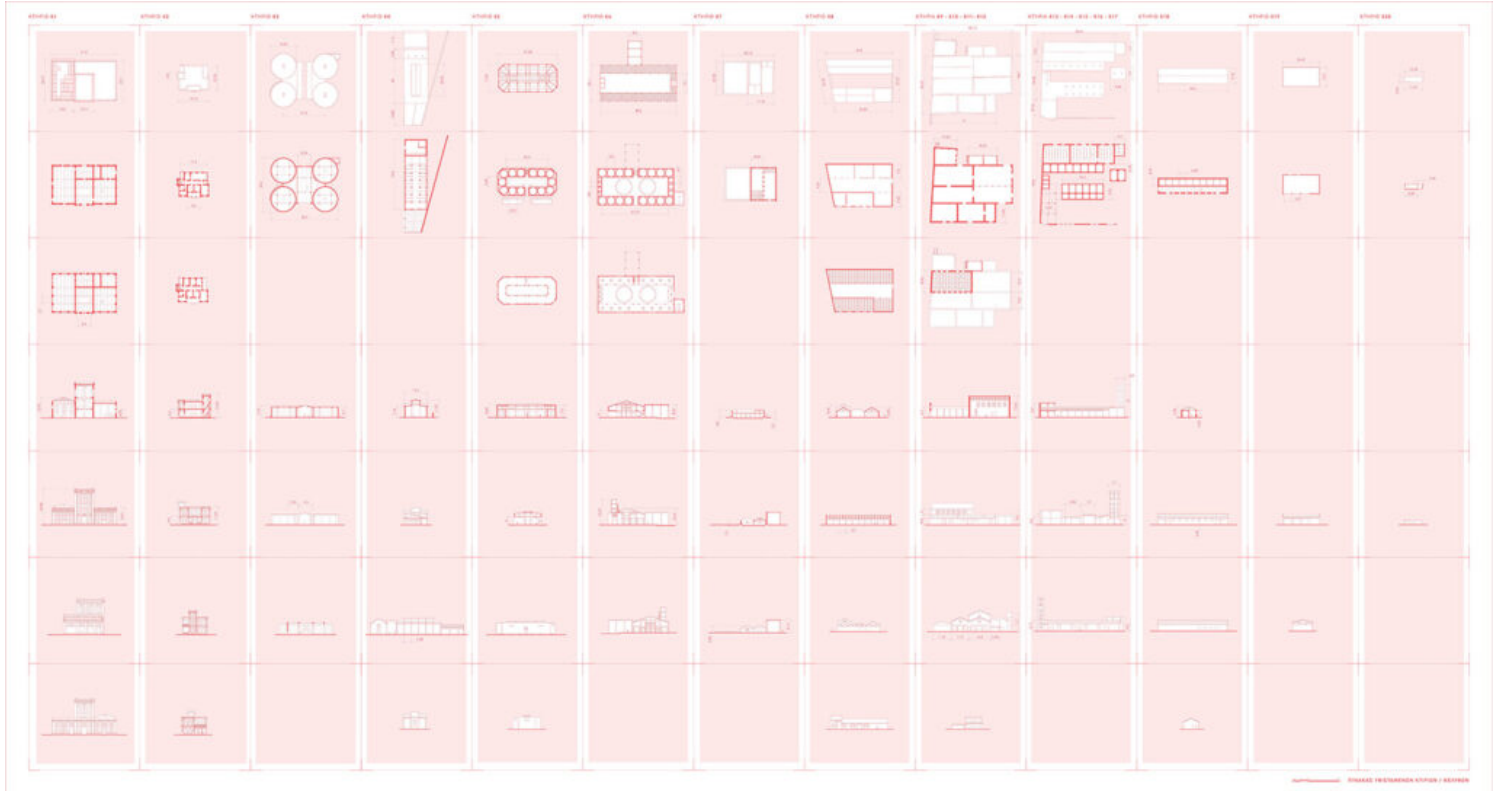



Figure 5: Table of design documentation of the existing buildings in their current state

urbanNext Lexicon

Repurposing Kronos: A Cultural and Communal Capacitor in Elefsina
<https://urbannext.net/repurposing-kronos-a-cultural-and-communal-capacitor-in-elefsina/>



care for HOUSING

Increasing job opportunities within the territory of Elefsina require new housing. Elefsina's Labour Centre in collaboration with the Open Care Centre for the Elderly could provide the potential for an intergenerational cohabitation for those in need of it. Living together, playing together, sharing time and doing activities together could turn out beneficial for everyone involved.



care for WELL BEING

Physical movement and creative activities reinforce wellness. Giving professional space to practice and to share knowledge and habits to keep up with a hobby, catch up with sports and get taught by those who know.

Public Spaces
The open spaces are designed to encourage the use of public spaces and to provide a place for social interaction.



Public Residences
The public residences are designed to provide a place for social interaction and to provide a place for social interaction.



Artists Residences
The artists residences are designed to provide a place for social interaction and to provide a place for social interaction.



Participatory Kitchen
The participatory kitchen is designed to provide a place for social interaction and to provide a place for social interaction.



Children Care
The children care is designed to provide a place for social interaction and to provide a place for social interaction.



Market Place
The market place is designed to provide a place for social interaction and to provide a place for social interaction.



Recreation Rooms
The recreation rooms are designed to provide a place for social interaction and to provide a place for social interaction.

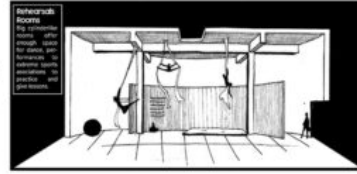

Outdoors
The outdoors are designed to provide a place for social interaction and to provide a place for social interaction.





care for CULTURE

From the preservation of a listed ex-industrial complex to the inclusion of artistic, traditional and contemporary activities the cultural sector remains active. Cultural spaces and practices refer to anyone, local or foreign.



care for NATURE

Bridging the gap between human nature and the long lost relationship with Elefsina's natural environment. Green spaces, small parks can contribute to the microclimate of the region and urban farming practices bring people closer to earth and provide for their needs.

Plaza
The plaza is designed to provide a place for social interaction and to provide a place for social interaction.



Greenhouse
The greenhouse is designed to provide a place for social interaction and to provide a place for social interaction.



Urban Farming - Free Market
The urban farming is designed to provide a place for social interaction and to provide a place for social interaction.



Library
The library is designed to provide a place for social interaction and to provide a place for social interaction.



Performing
The performing is designed to provide a place for social interaction and to provide a place for social interaction.



Art
The art is designed to provide a place for social interaction and to provide a place for social interaction.



Urban Farming - Free Market
The urban farming is designed to provide a place for social interaction and to provide a place for social interaction.



Figure 6: Scenarios for the re-inhabitation of "KRONOS" as presented at Mystery 79 Beyond the Obvious 2023, Handle with Care Agora, 2023 Elefsis European Capital of Culture

The proposed demolition and functional adaptation strategy aims to preserve as many buildings as possible, minimizing construction waste while maintaining the integrity and memory of *KRONOS* as a cohesive complex rather than a collection of individual listed buildings.

The reuse program, designed to meet the needs of the city and its inhabitants, is organized into functional subdivisions (zones) within the industrial complex :

- **Public Zone:** This area highlights the supra-local and public character of the city. It includes a main square, an exhibition space, a café, a library, and a market, creating vibrant spaces for interaction and cultural exchange.
- **Communal Zone:** Addressing the needs of the local community, this zone provides spaces for cultural associations, short-term housing for artists, urban farming initiatives, and outdoor play areas.
- **Private Zone:** Dedicated to intergenerational social housing, this zone offers accommodations for young people, families, and the elderly. It also includes essential communal and recreational spaces to promote social interaction and well-being .

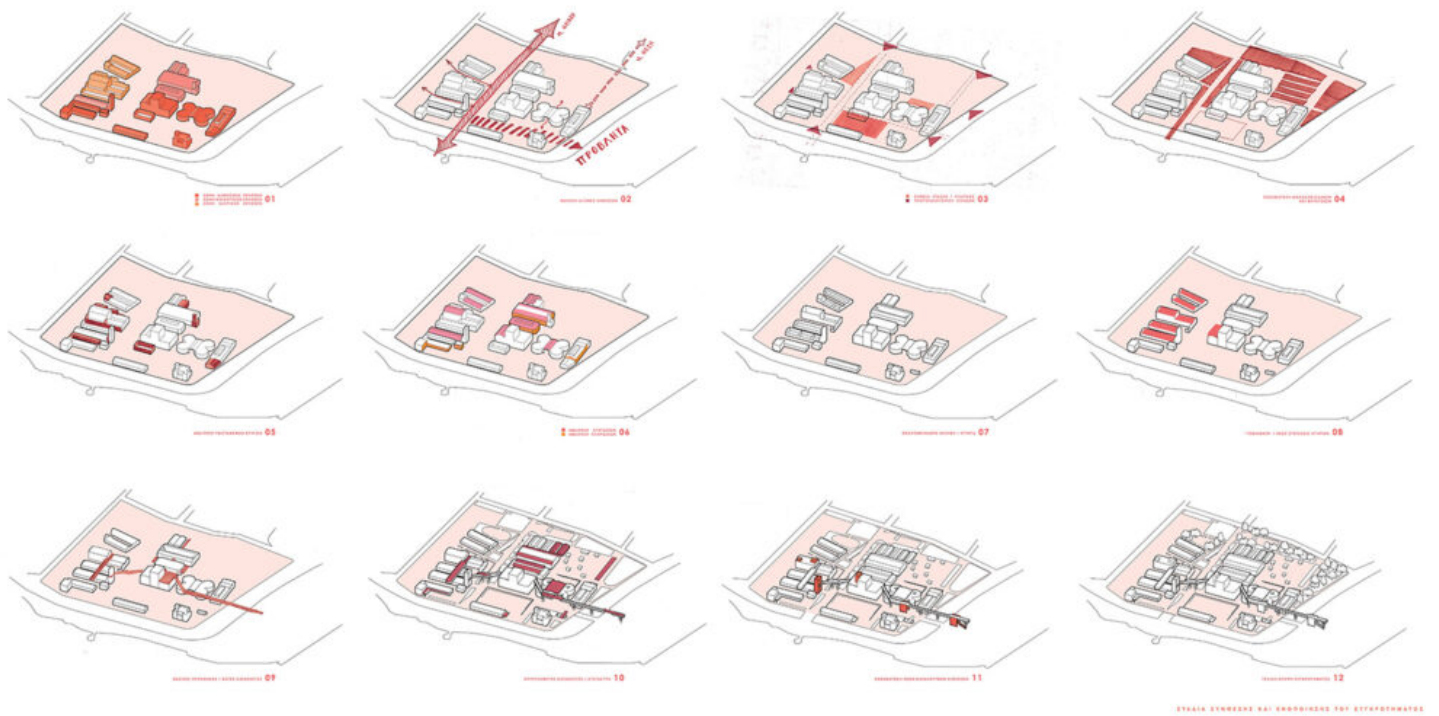

Figure 7: Diagrams of the reuse of "KRONOS"

urbanNext Lexicon

Repurposing Kronos: A Cultural and Communal Capacitor in Elefsina
<https://urbannext.net/repurposing-kronos-a-cultural-and-communal-capacitor-in-elefsina/>

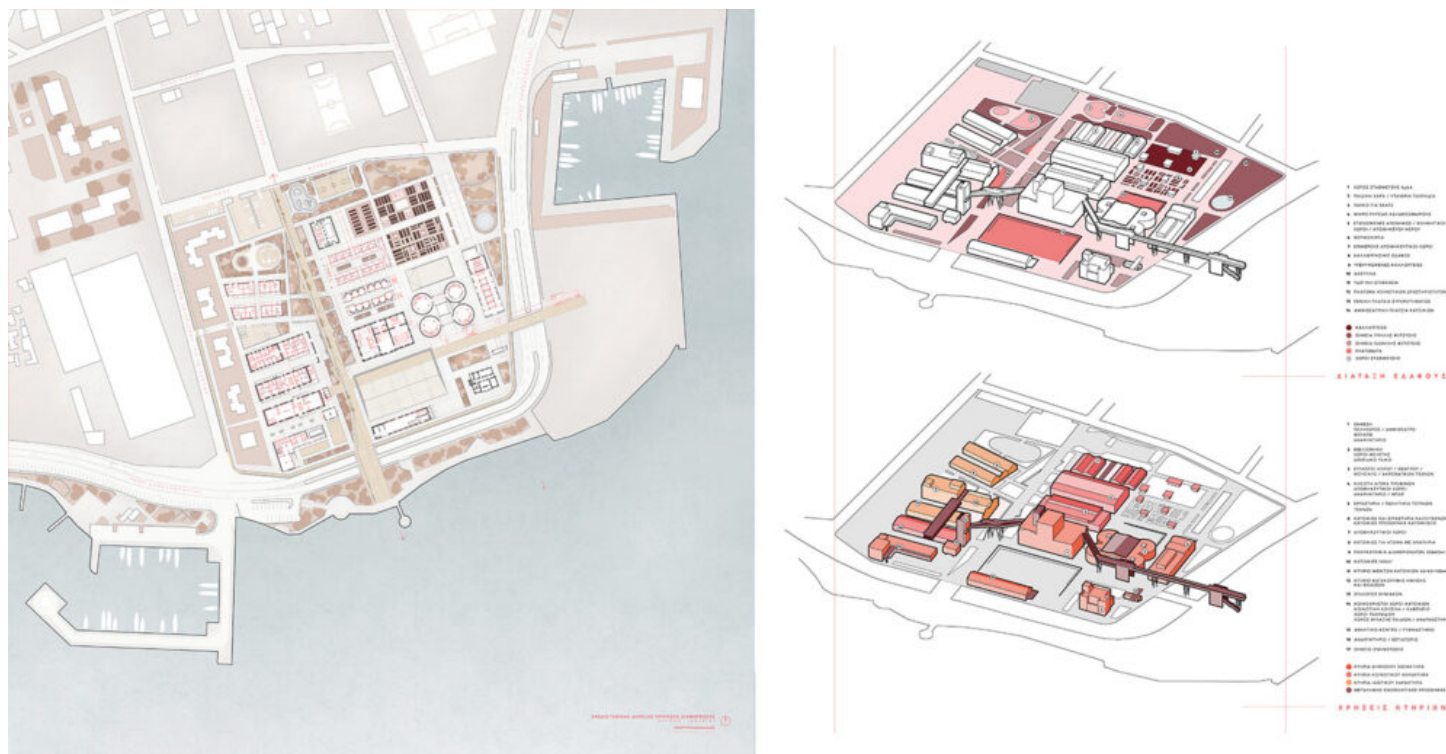
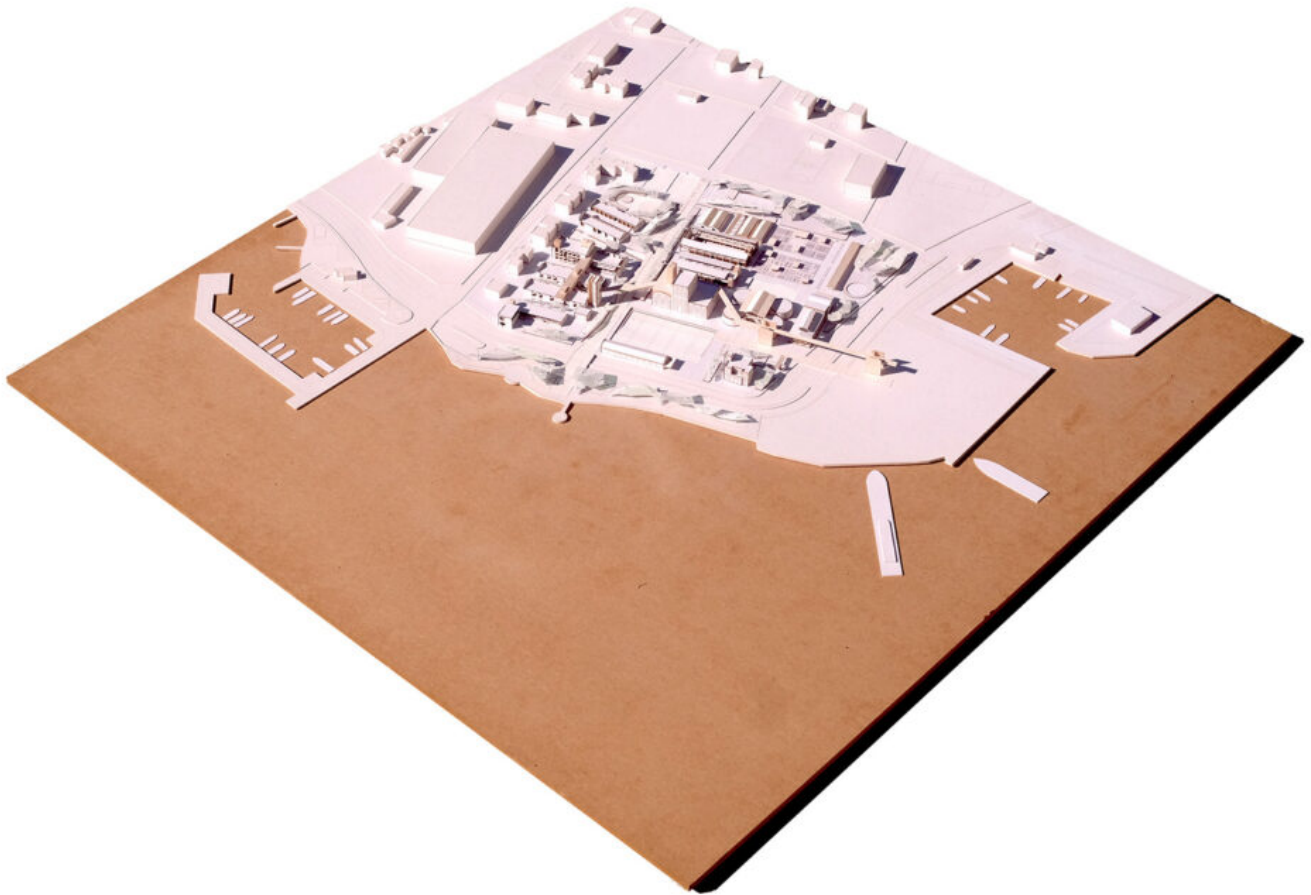

Figure 8: General layout plan of the proposal for the re-use of "Kronos" and functional diagrams

urbanNext Lexicon

Repurposing Kronos: A Cultural and Communal Capacitor in Elefsina
<https://urbannext.net/repurposing-kronos-a-cultural-and-communal-capacitor-in-elefsina/>



Εξθεσιακός χώρος | χώρος παρκαρίων



Θύρα/Είσοδος | Αρχείο ΚΡΟΝΟΣ



Παλαιστική Σάλλαγοι (Π.Α.Κ.Π.Α.Ϊ)



Μόνιμη αγορά



Καλλιτεχνικό εργαστήριο



Κεντρικός καλλιτεχνών



Αναψυρακία | Άουτντ



Αναμνηστήριο με γραφείο πληροφόρησης

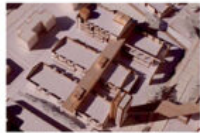

Κατοικίες (Εργατοσυνδικαλιστικό - Κ.Α.Π.Η.)



Κατοικίες Α.μ.Α.

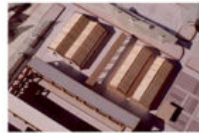

Ευμερότητα | Αποθηκευτικός χώρος



Αστικός Καλλιέργειας

ISSN : 2575-5374

Figure 9: Model at a scale of 1:500

The connection between the proposed zones of the complex, as well as their integration with the city, is achieved through the creation of new circulation axes, public squares, and the construction of an elevated promenade. This promenade serves as a prominent "stitching" element, linking the usable levels of the buildings, connecting the buildings themselves, and uniting the entire complex with the historic *KRONOS* pier.

The reuse process is designed to unfold in chronological phases, allowing for the progressive re-inhabitation of the complex from the moment it is entrusted to the city. The goal is to establish a new functional operation for *KRONOS* that addresses local needs and incorporates simultaneous habitation scenarios.

Interventions on the ground and within the built environment of the complex are deliberately lightweight and contrasting. They aim to unify the space, facilitate functional interconnections between new activities, and highlight the significance of the buildings as part of the larger whole .



Figure 10: Plan and elevation of a part of the complex at a scale of 1:200



Figure 11: Model of part of the complex at a scale of 1:200 and selected views of the complex



Figure 12: Views of the model and sections at a scale of 1:200



Figure 13: Sectional drawing of the exhibitions' and associations' building in scale 1:100

