

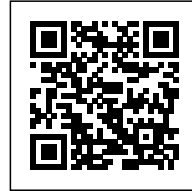

URBAN PARK TULTILAN

Posted on July 1, 2021 by martabuges



Categories: [Low Density](#), [PRODUCTORA](#), [Project](#), [Territory and mobility](#), [Urban Paradigms](#)

Tags: [Active Public Spaces](#), [Leisure](#), [Mexico](#), [Multifunctional space](#), [Multiscale approach](#), [Project](#), [Public Catalyst](#), [Residential](#)

urbanNext Lexicon

Urban Park Tultilán

<https://urbannext.net/urban-park-tultilan/>

The project, located in the Hogares Castera housing unit in the Municipality of Tultitlán, is an initiative made by INFONAVIT and the CIDS (Research Center for Sustainable Development). It mainly consists of a 15-meter-wide by 200-meter-long concrete corridor, along which various elements in colored concrete are grouped together to form recreation spaces.



ISSN : 2575-5374

urbanNext Lexicon

Urban Park Tultilan
<https://urbannext.net/urban-park-tultilan/>



ISSN : 2575-5374

urbanNext Lexicon

Urban Park Tultilan
<https://urbannext.net/urban-park-tultilan/>



The first of the elements is a set of 50 x 50 cm cubes arranged along the lineal corridor to create a meeting point. Next we find a multi-purpose triangular pavilion.

ISSN : 2575-5374

urbanNext Lexicon

Urban Park Tultilan
<https://urbannext.net/urban-park-tultilan/>



ISSN : 2575-5374

urbanNext Lexicon

Urban Park Tultilan
<https://urbannext.net/urban-park-tultilan/>



ISSN : 2575-5374

urbanNext Lexicon

Urban Park Tultilan
<https://urbannext.net/urban-park-tultilan/>



ISSN : 2575-5374

urbanNext Lexicon

Urban Park Tultilan
<https://urbannext.net/urban-park-tultilan/>



ISSN : 2575-5374

urbanNext Lexicon

Urban Park Tultilan

<https://urbannext.net/urban-park-tultilan/>



More recreational elements round out the trajectory, such as: an element for public events with a flagpole; a series of triangular walls forming a play area; an elongated wedge shape which functions as both a climbing structure and a grandstand; a small circular platform; and another small platform that occupies part of the corridor and part of a garden attached to it. Surrounding the corridor is a wooded area with multipurpose courts, an outdoor gym and a series of children's play areas.

ISSN : 2575-5374

urbanNext Lexicon

Urban Park Tultilan
<https://urbannext.net/urban-park-tultilan/>

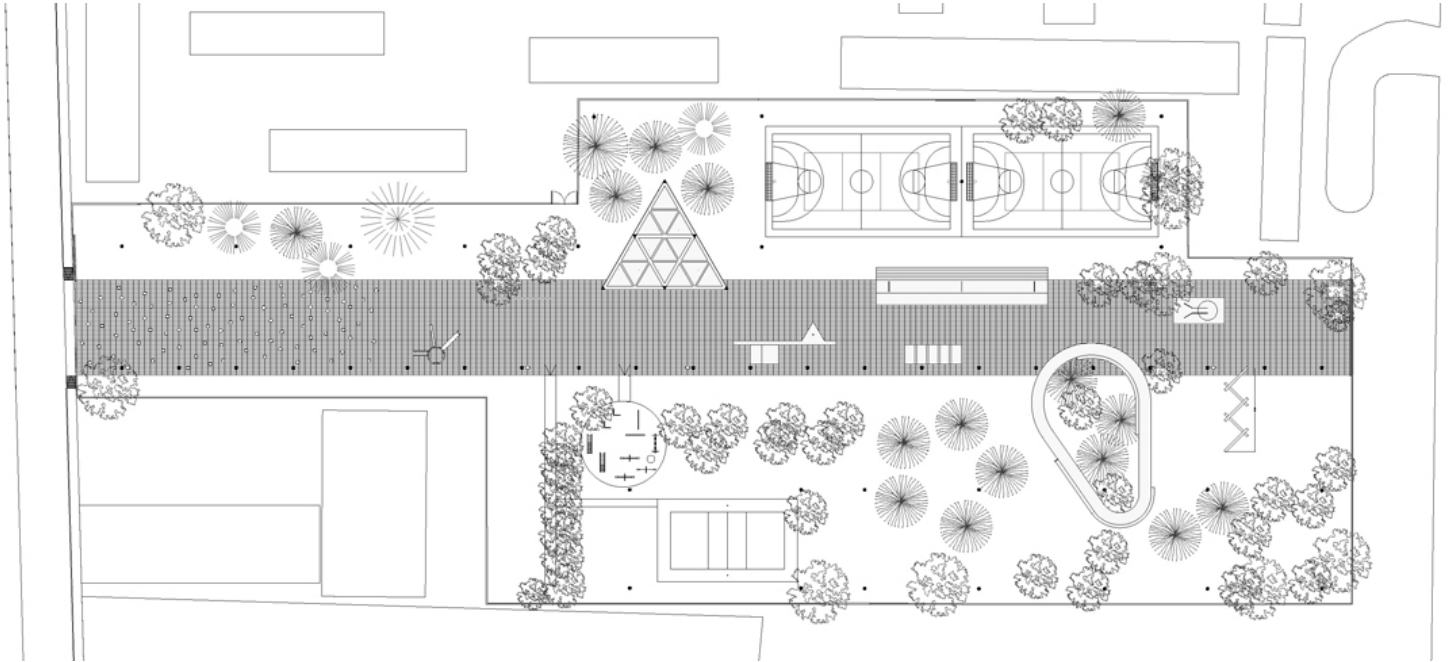

ISSN : 2575-5374

urbanNext Lexicon

Urban Park Tutilan
<https://urbannext.net/urban-park-tutilan/>

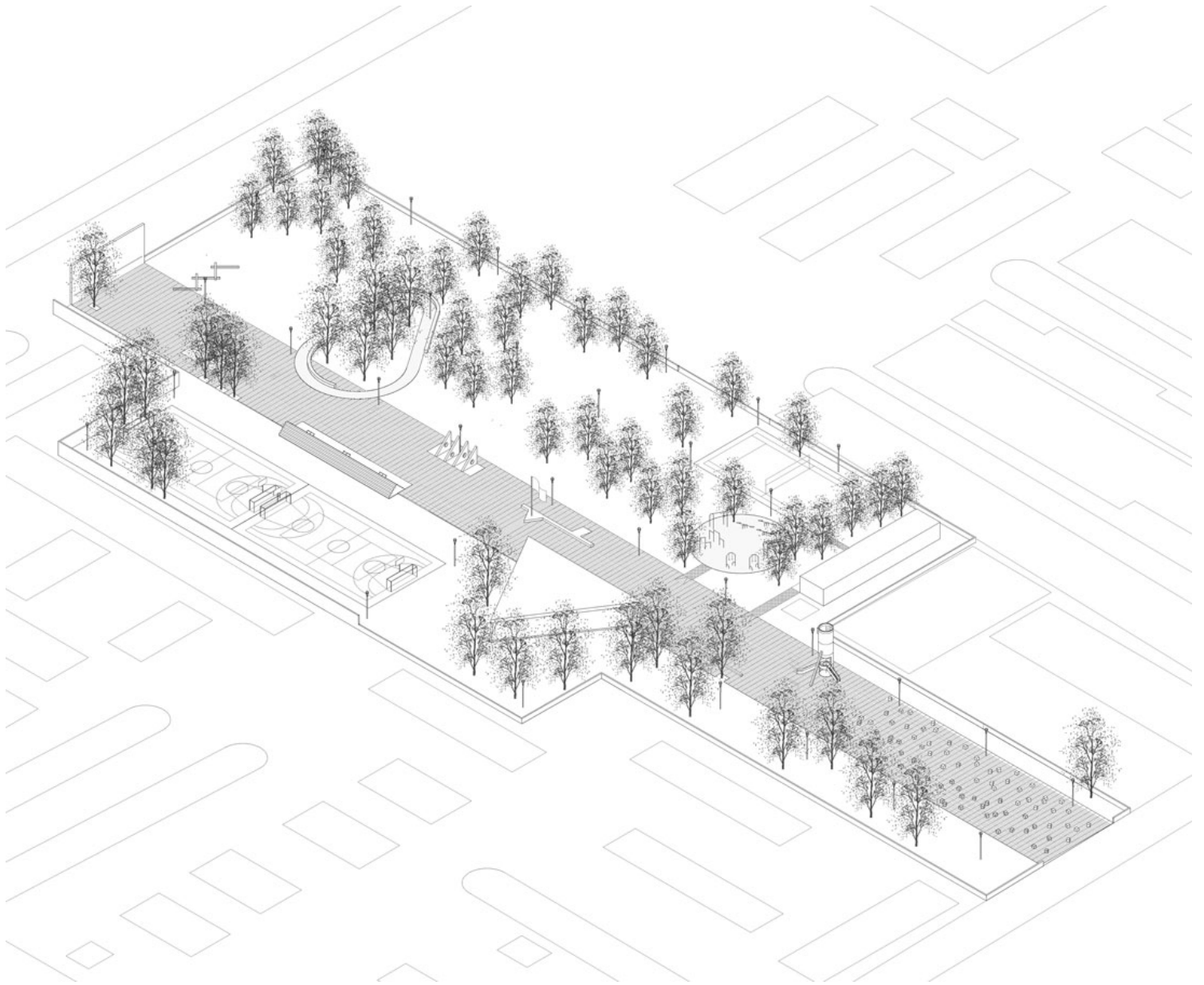

ISSN : 2575-5374

urbanNext Lexicon

Urban Park Tutilan
<https://urbannext.net/urban-park-tutilan/>