

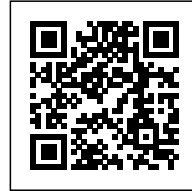

## DOCKLANDS CITY PARK

*Posted on September 22, 2016 by urbanNext*



**Categories:** [High Density](#), [MALA studio](#), [Project](#), [Territory and mobility](#)

**Tags:** [Active Public Spaces](#), [Agency of Urban Organization](#), [Australia](#), [Building Landscape Urbanism](#), [Built landscape](#), [City space](#), [Community Facilities](#), [Concrete](#), [Connections](#), [Controlling nature](#), [Ecological agencies](#), [Ecological footprint](#), [Ecological researches](#), [Ecological urbanism](#), [Landscape](#), [Landscape Architecture](#), [Landscape planning](#), [Landscape urbanism](#), [Melbourne](#), [Multifunctional space](#), [Natural connectors](#), [Park](#), [Project](#), [Public Space](#), [Reconstructing nature](#), [Steel](#), [Territorial Approach](#), [Timber](#), [Urban catalyst](#), [Urban Health](#), [Urban Paradigms](#), [Urban space](#), [Vegetation](#)

# urbanNext Lexicon

Docklands City Park

<https://urbannext.net/docklands-city-park/>

The relocation of the 2015 MPavilion triggered the funding and implementation of Stage 1 of the CLEC Master Plan (the eastern portion of Docklands Park).



ISSN : 2575-5374



# urbanNext Lexicon

Docklands City Park

<https://urbannext.net/docklands-city-park/>



MALA recently developed the master plan for Places Victoria to transform the dilapidated eastern portion of Docklands Park into a thriving new recreational and cultural hub. The master plan seeks to link community buildings, multi-purpose courts, public art, existing parklands and the new MPavilion precinct with a series of recreational and garden spaces.

ISSN : 2575-5374



# urbanNext Lexicon

Docklands City Park  
<https://urbannext.net/docklands-city-park/>

## LEGEND

- 1 M PAVILION
- 2 DECK SEAT BENEATH TREE
- 3 CONCRETE SEAT EDGE
- 4 GRAVEL BREAKOUT
- 5 FLAT LAWN
- 6 TITLED LAWN
- 7 GARDEN BED
- 8 GREEN PARK/ GAS EASEMENT
- 9 MULTI-PURPOSE COURTS
- 10 FOOTPATH
- 11 EXERCISE ZONE
- 12 RAISED DECK
- 13 RELOCATED ART



## MASTERPLAN

### Plan

The master plan proposes a new sport fitness park, outdoor exercise equipment, ping pong tables, multipurpose spaces for yoga, dance, aerobics and personal training classes, hard and soft pedestrian paths and quiet garden nooks.

ISSN : 2575-5374

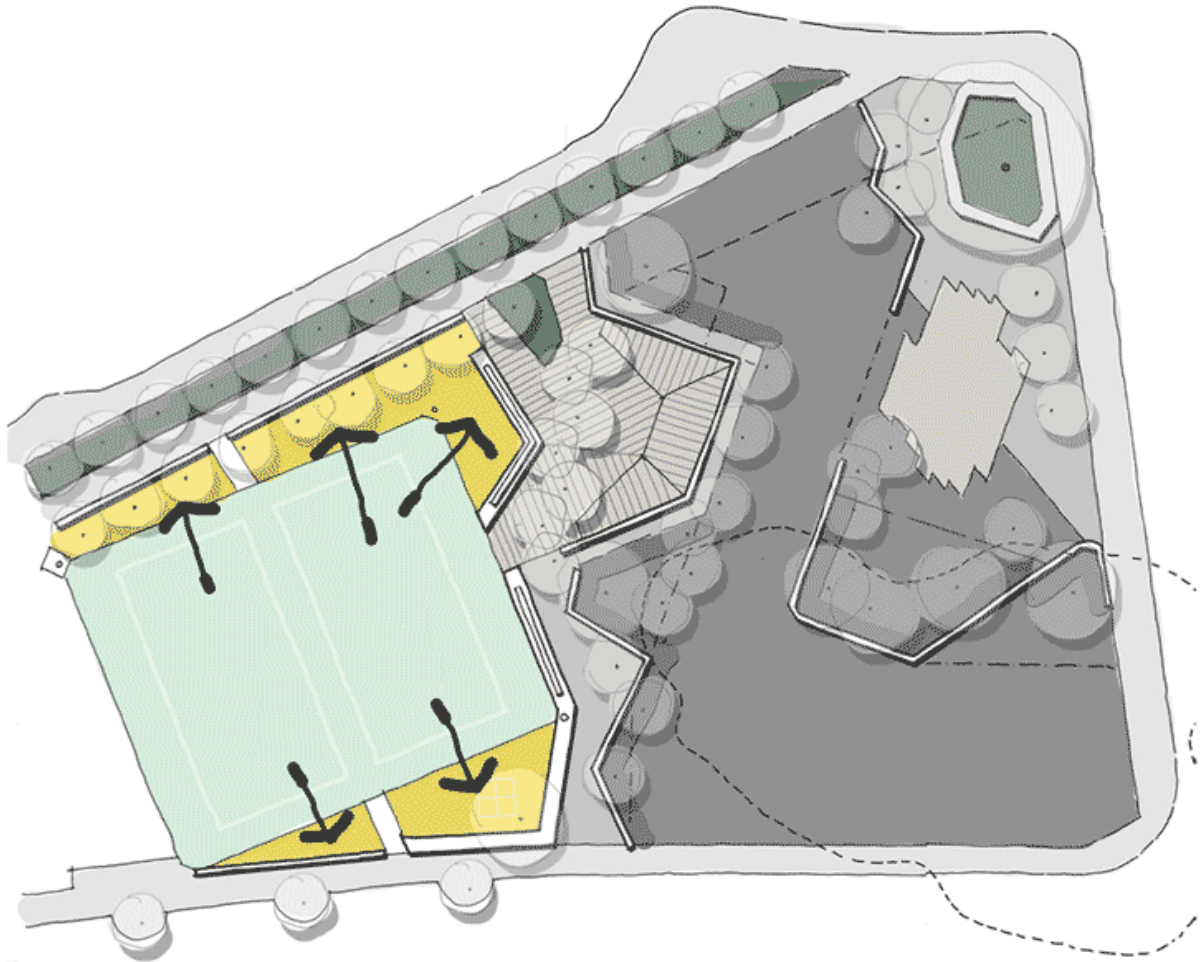

## ENHANCE THE COURTS

Improve the spectating periphery spaces to the east and west of the existing multi courts.



# urbanNext Lexicon

Docklands City Park

<https://urbannext.net/docklands-city-park/>

## Diagrams

Stage 1 was really about celebrating the MPavilion and enhancing its parkland setting. We wanted to provide a beautiful landscape for the pavilion that allowed people to interact not only with the architecture but with the surrounding park as well. The MPavilion is such a dynamic piece of architecture, it was important the landscape did not try to compete with it.



ISSN : 2575-5374



# urbanNext Lexicon

Docklands City Park

<https://urbannext.net/docklands-city-park/>



One of our initial concerns was the MPavilion being set against the backdrop of Harbour Esplanade. The key design move was to create a tilted lawn and a modern Ha-ha wall behind the MPavilion. The Ha-ha wall is an ancient design device used to create clear and seamless view lines within the landscape. In this instance, we have used it to create a green background for the pavilion and provide an interrupted view to the western portion of the Docklands Park behind. The tilted lawn also creates a natural amphitheatre for the MPavilion and provides a lovely space to sit or lounge under the dappled shade of the existing eucalypts.

ISSN : 2575-5374



# urbanNext Lexicon

Docklands City Park  
<https://urbannext.net/docklands-city-park/>



Another key feature of the landscape is the new circular deck seat beneath the large peppercorn tree. The peppercorn is over 100 years old and was the single biggest asset on an otherwise dilapidated site. We worked closely with arborist Steve Fitzgerald to carefully design the seat, which now provides a protected place to meet, gather, sit, eat and read. Located on the prominent corner of Collins Street, the new deck seat and concrete ribbon seat wall create a formal entry into the site.

ISSN : 2575-5374



# urbanNext Lexicon

Docklands City Park  
<https://urbannext.net/docklands-city-park/>

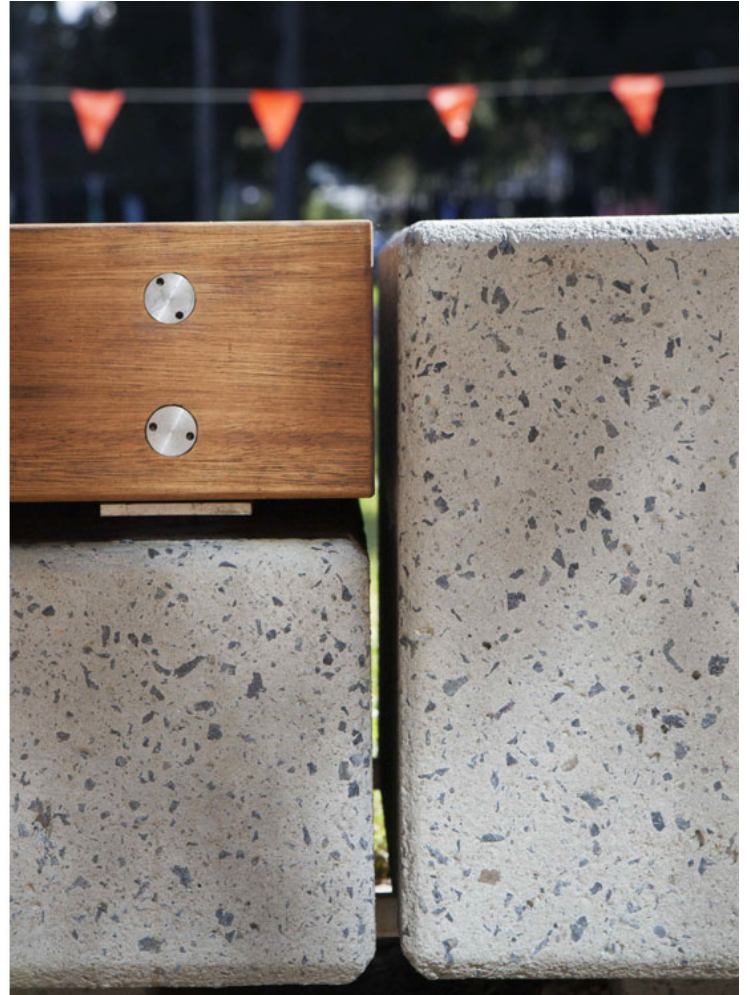

ISSN : 2575-5374



# urbanNext Lexicon

Docklands City Park

<https://urbannext.net/docklands-city-park/>

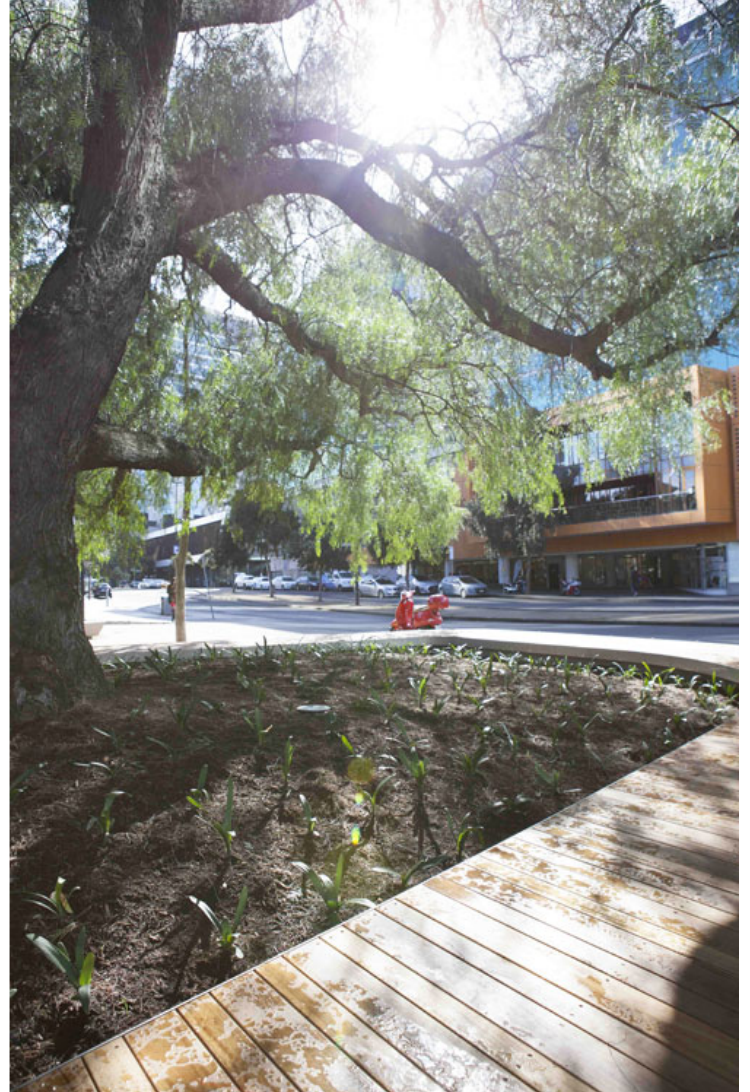

The implementation of the MPavilion precinct marks the completion of first stage of the master plan. The design enhances and celebrates the MPavilion and its new parkland setting. Iconic Docklands materials such as concrete, steel and timber are counterbalanced with generous lawns and gardens to invite the visitor to sit, eat, read, play and socialize amongst the hustle and bustle of the city.

ISSN : 2575-5374



# urbanNext Lexicon

Docklands City Park

<https://urbannext.net/docklands-city-park/>

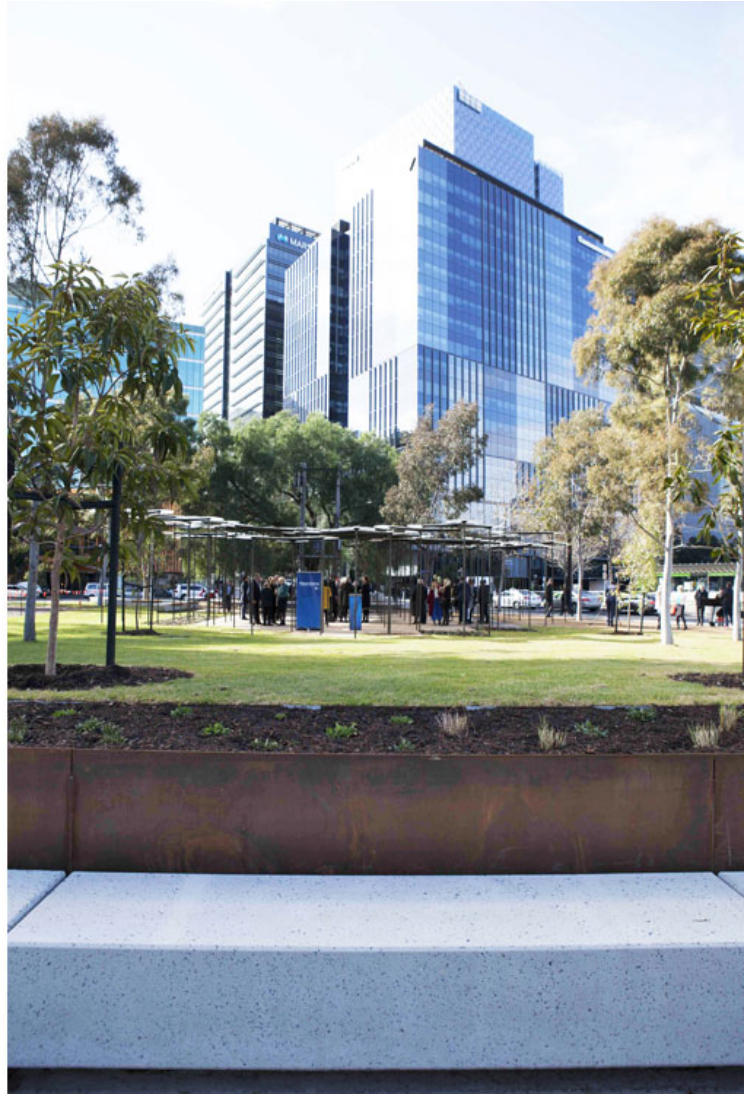

Over the past 15 years, Melbourne's Docklands has been converted from an abandoned industrial precinct into a new residential, commercial and sporting hub. The revitalization of Docklands Park marks the newest chapter in the urban renewal project and compliments other public spaces such as Victoria Green and Ron Barassi Snr Park.

ISSN : 2575-5374



# urbanNext Lexicon

Docklands City Park  
<https://urbannext.net/docklands-city-park/>



MALA studio is thrilled to have been involved in this project. The site is one of the last pieces of public open space in the Docklands and we welcome Places Victoria, the City of Melbourne and the Naomi Mailgrams Foundation's vision to provide a space of cultural and recreational significance.

ISSN : 2575-5374



# urbanNext Lexicon

Docklands City Park  
<https://urbannext.net/docklands-city-park/>



ISSN : 2575-5374



# urbanNext Lexicon

Docklands City Park

<https://urbannext.net/docklands-city-park/>



ISSN : 2575-5374



# urbanNext Lexicon

Docklands City Park  
<https://urbannext.net/docklands-city-park/>



ISSN : 2575-5374



# urbanNext Lexicon

Docklands City Park  
<https://urbannext.net/docklands-city-park/>

ISSN : 2575-5374